

TileEzy

SHOWER BASE

TECHNICAL MANUAL

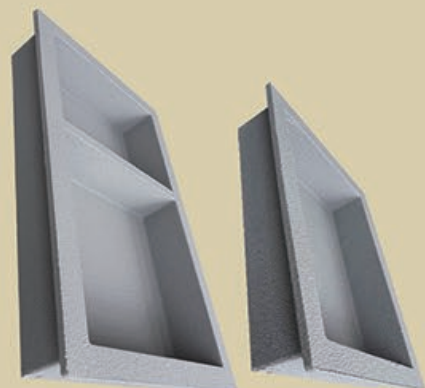
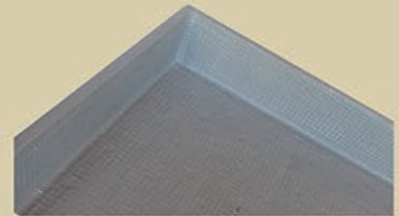
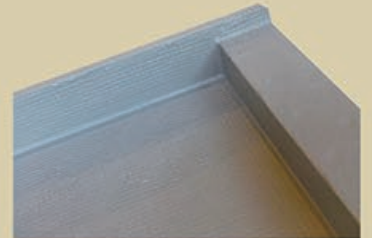
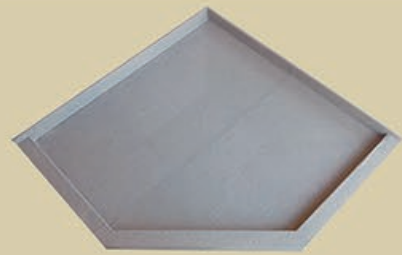

Elim New Zealand Ltd
<http://showerbase.co.nz>

TileEzy Shower Tray

The TileEzy Shower Bases (TESB), is a range of construction products designed for use in showers where tiled floors and walls are specified. The range offers a reliable, watertight, and aesthetic pleasing solutions for shower installations. It's a better option for tiled showers to satisfy client's watertight and aesthetical requirements.

Installation of the TESB shall be by personnel trained and approved by ELIM New Zealand Ltd.

Floor substrates must be dry, clean and stable before installation. Surfaces must be smooth and free from nibs, sharp edges, dust, dirt or other materials such as oil, grease or concrete formwork release agents.

New concrete must use wall tile adhesive to install.

The moisture content of any new timber floor and or Fibrecement and plywood sheet shall be dry with a moisture content being no greater than that stipulated by the manufacturer, at the time of installation.

Installation must strictly follow ELIM New Zealand Ltd provide the installation manual.

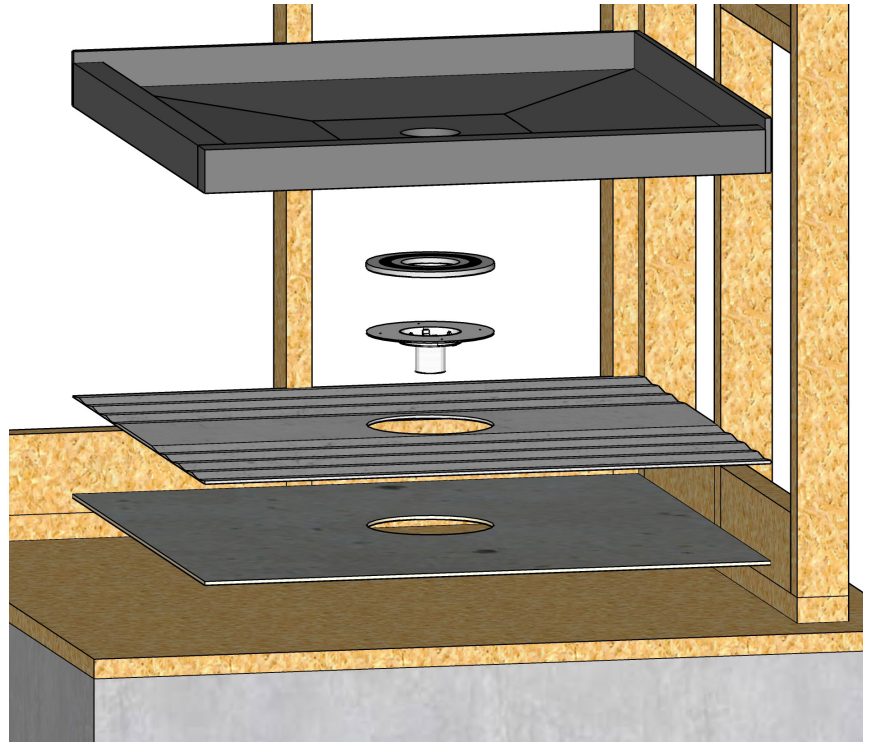

ELIM New Zealand Ltd, Unit3, 4 workspace dr, Hobsonville, Auckland
Phone: 09 4142968

<http://showerbase.co.nz>

Installation Instructions



Fix and make sure the fibre-cement floor is level and even. Supporting Nogs need to be installed before the installation of the Shower Base.



Clean the substrate, check and make sure that the top of the waste flange and all its fixing screws are no higher than the floor substrate.



Mark the centre of the hole point on the TileEzy Shower Base and drill the hole. The hole diameter is typically between 120mm to 150mm to suit.

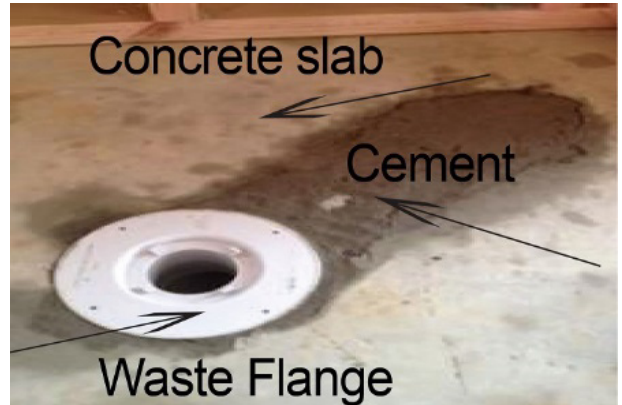

Or, fix and make sure the concrete floor surface is level and even.



Measure the distance between the centre of the waste outlet and the bottom plate of the framing of the nearest wall.



Put the TileEzy Shower Base in the installation position; then draw lines around edge of the TileEzy.



ELIM New Zealand Ltd, Unit3, 4 workspace dr, Hobsonville, Auckland
Phone: 09 4142968

<http://showerbase.co.nz>

Installation Instructions



Apply the EzySeal evenly around the waste flange as shown in the photo.



Apply the approved neutral cure sealant around the wastepipe outlet, then around the outside of the EzySeal as shown in the photo.



Apply a flexible tile adhesive using a 5mm notched trowel, as shown in the photo.

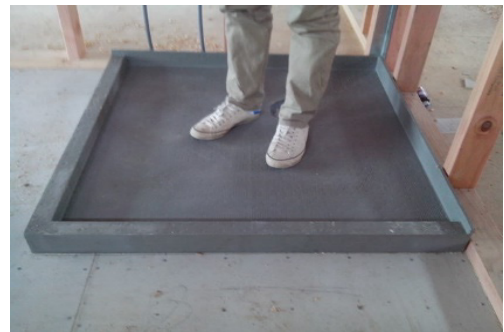

Making sure the TileEzy is hard up against the bottom plate, ensure the shower base is evenly adhered to the floor.



Apply a bead of the neutral cure sealant around the edge of the hole in the shower base, as shown in the photo.



Using a flat clean piece of plywood or plastic spatula shape the sealant, as shown in the photo.



Protection with packing box. No walking on inside 24 hours.



Wall lining is installed ready for waterproofing and tiling.

Shower Tray Details

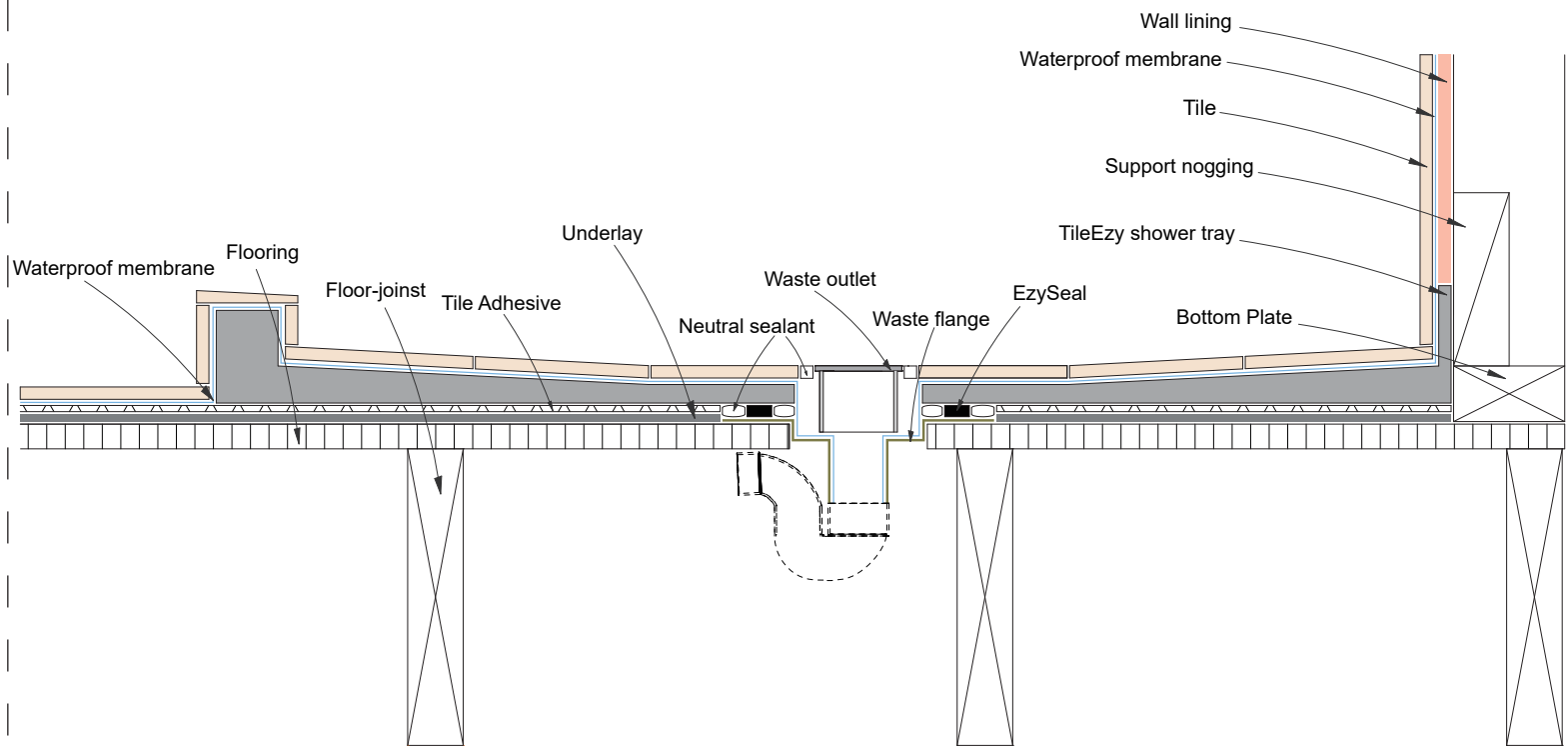

Fig 1. Standard Tray Section

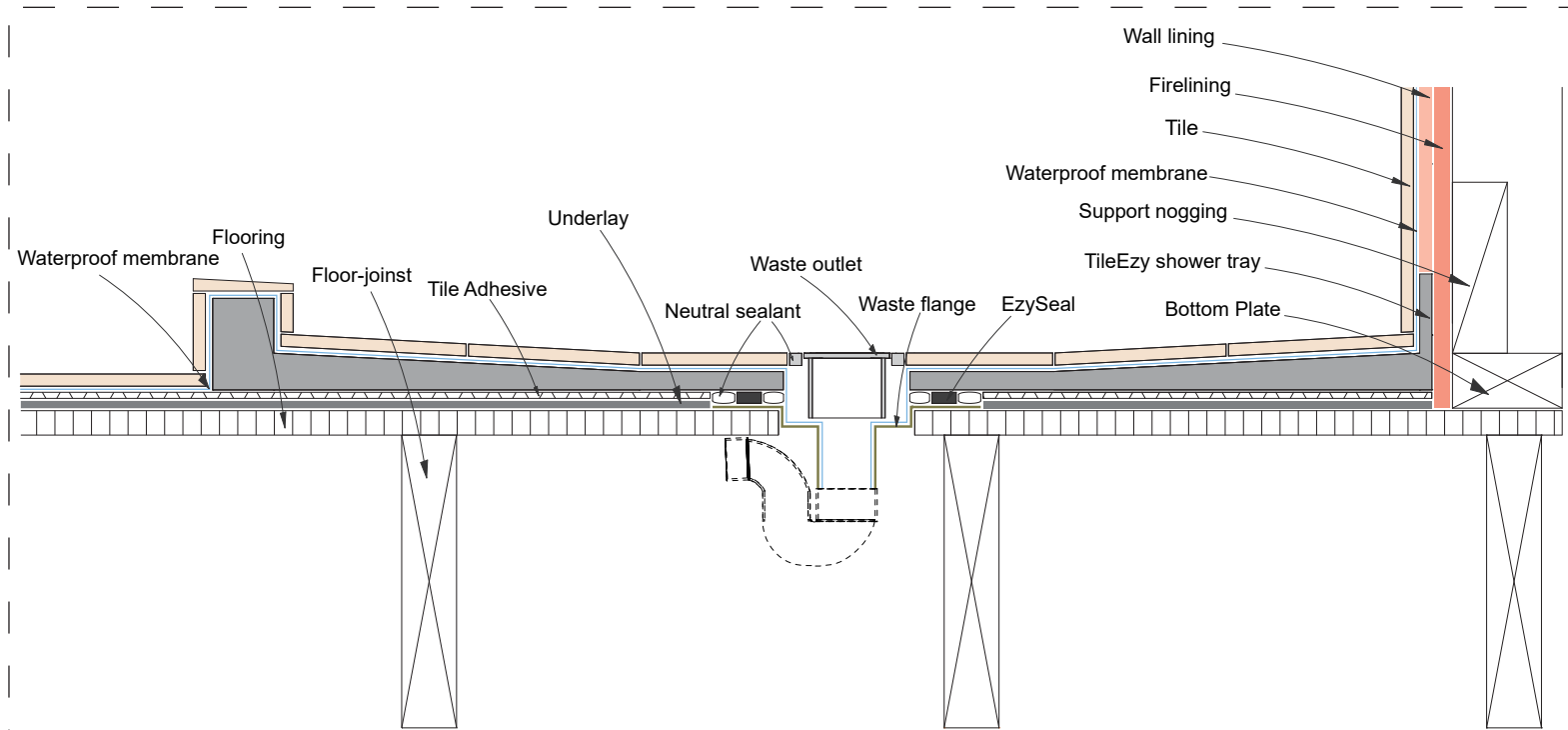

Fig 2. Tray With Firewall Section



ELIM New Zealand Ltd, Unit3, 4 workspace dr, Hobsonville, Auckland
 Phone: 09 4142968

<http://showerbase.co.nz>

Shower Tray Details

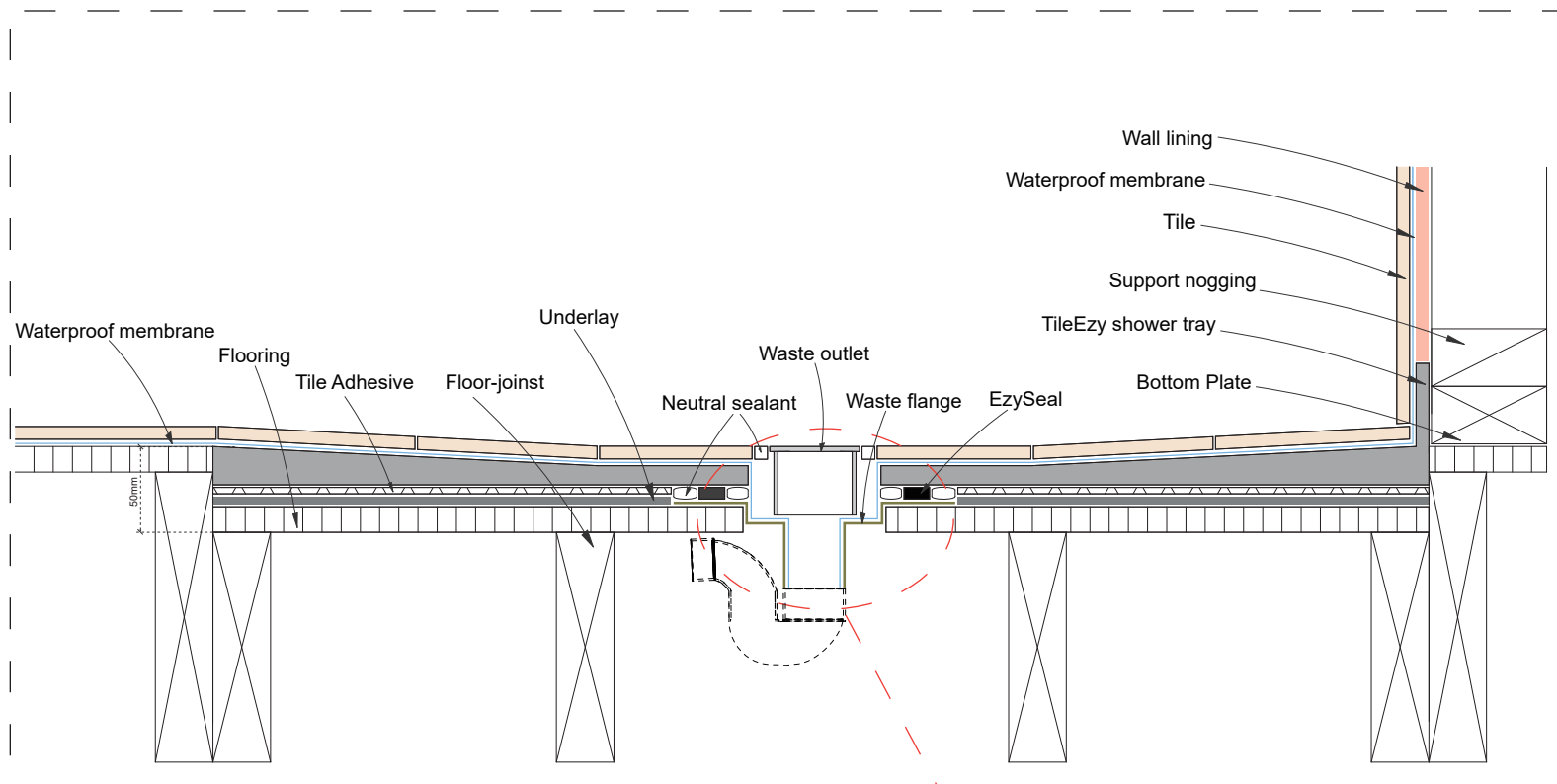

Fig 3. Level Entry Tray Section

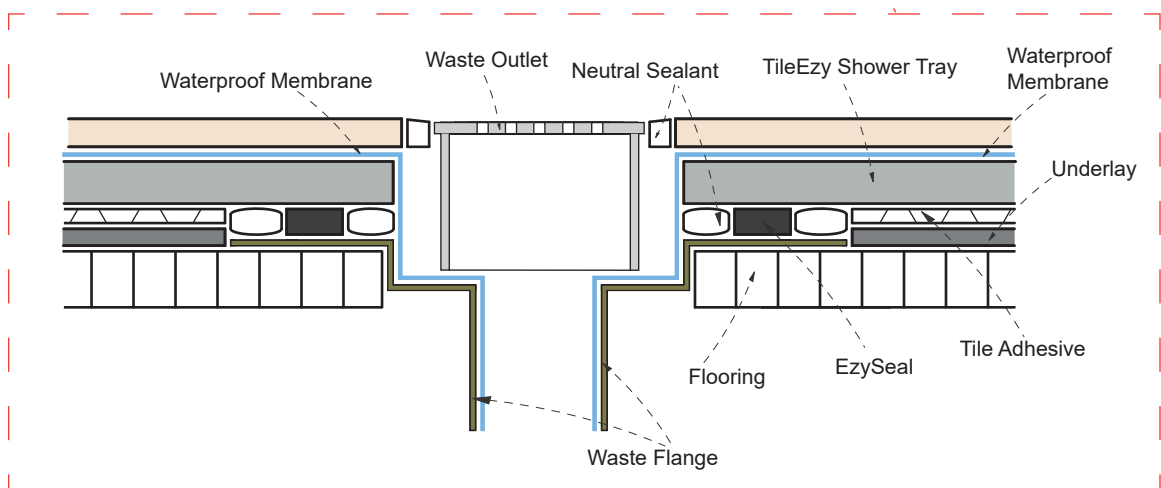

Fig 4. Waste Outlet Details



ELIM New Zealand Ltd, Unit3, 4 workspace dr, Hobsonville, Auckland
 Phone: 09 4142968

<http://showerbase.co.nz>